



# NE-51

## 高溫急速冷卻機 組裝操作說明書

### High Temperature Instant Cooling Machine NE-51 User's Manual Installation process

辰光能源科技有限公司 **Sunshine Energy Technology Co., Ltd.**

TEL: 886-49-2200283

FAX: 886-49-2247383

Website: [www.sunshine-new.com](http://www.sunshine-new.com)

E-mail: [msch6688@gmail.com](mailto:msch6688@gmail.com)

Address: 54060 南投市大庄路 72-1 號 / No. 72-1, Dajuang Rd., Nantou City, 54060 Taiwan

# DIY 機械組裝說明

## Illustration of DIY Machine Installation

### 1. 升降結構組裝 Fabrication of lift up and down control pole.



雙人完成至固定位置 → 取出使用工具與 m8\*20mm 結合零件。

Two people are needed, use m8\*20mm screws and nuts to fabric the pole and NE-51.

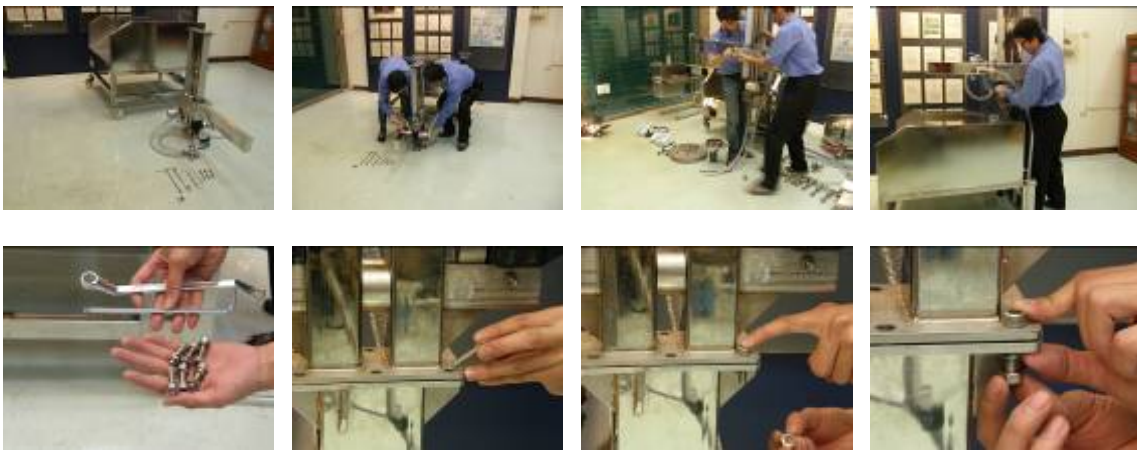

使用 6 號六角板手與 13 號梅花板手鎖緊即可。

Use no. 6 ratcheting wrench and no.13 wrench to fasten the screws



完成升降結構 The installation is done.

## 2. 旋轉機構組裝 Turntable construction fabrication.



先置入旋轉馬達結構，再放上平面固定盤。

First, put in the turntable motor and then put on the turntable plate.



取出控制盒組，放置前門固定位置。

Take the time control system box and put it in the front door of NE-51.



安裝電控防水接頭

Connect the military plug.





### 3. 水套結構組裝 NE-51 water tank fabrication



水套置放於油壓板車上單人即可定位。

Put the water tank on the forklift, so the water tank can be put on the lift pole by single person.



水套上部□型吊環慢慢跨入揚升橫桿，至標示定位點。

□ shape on the top of water tank, please move across the lift pole until the □ shape reaches the round circle.



以六角板手將水套微調至最佳位置鎖緊，完成組裝。

Use no. 6 ratcheting wrench to fasten the screws, the fabrication of water tank is done.

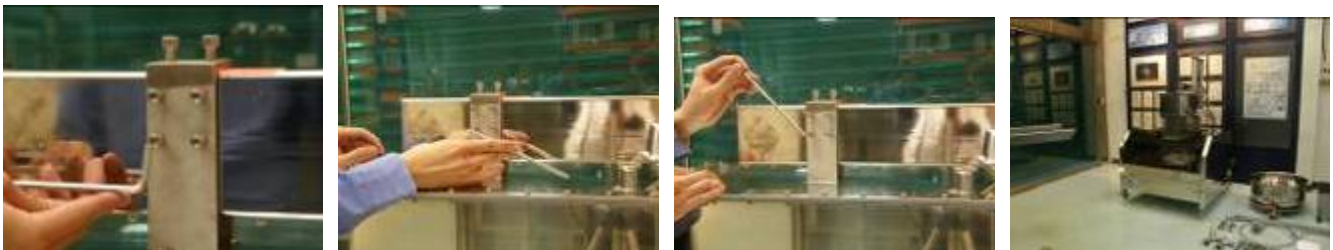

#### 4. 水套進水管路組裝 Water in and water out pipes connection to the water tank.

取出夾式快拆固定環與矽膠止水墊圈，出水與入水夾片尺寸不同所以不會安裝錯誤。

Use the C clamps and silica washer to connect the pipes, the size of two pipes are different, so there would not be confused on connection.



出水管安裝 The connection of water out pipe.

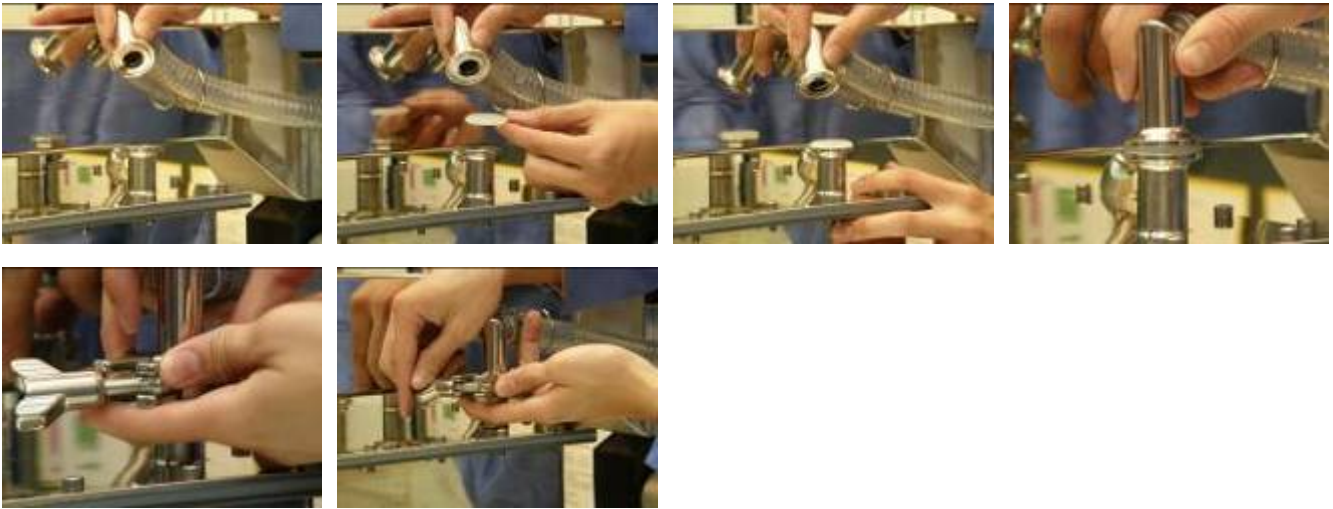

進水管安裝 The connection of water in pipe.





安裝機組後方入水管 Water in pipe behind NE-51 connection.



5. DIY 排水管路安裝 DIY machine drain pipes connection.



機組排水管路安裝 The connection of the machine water out drain pipes.

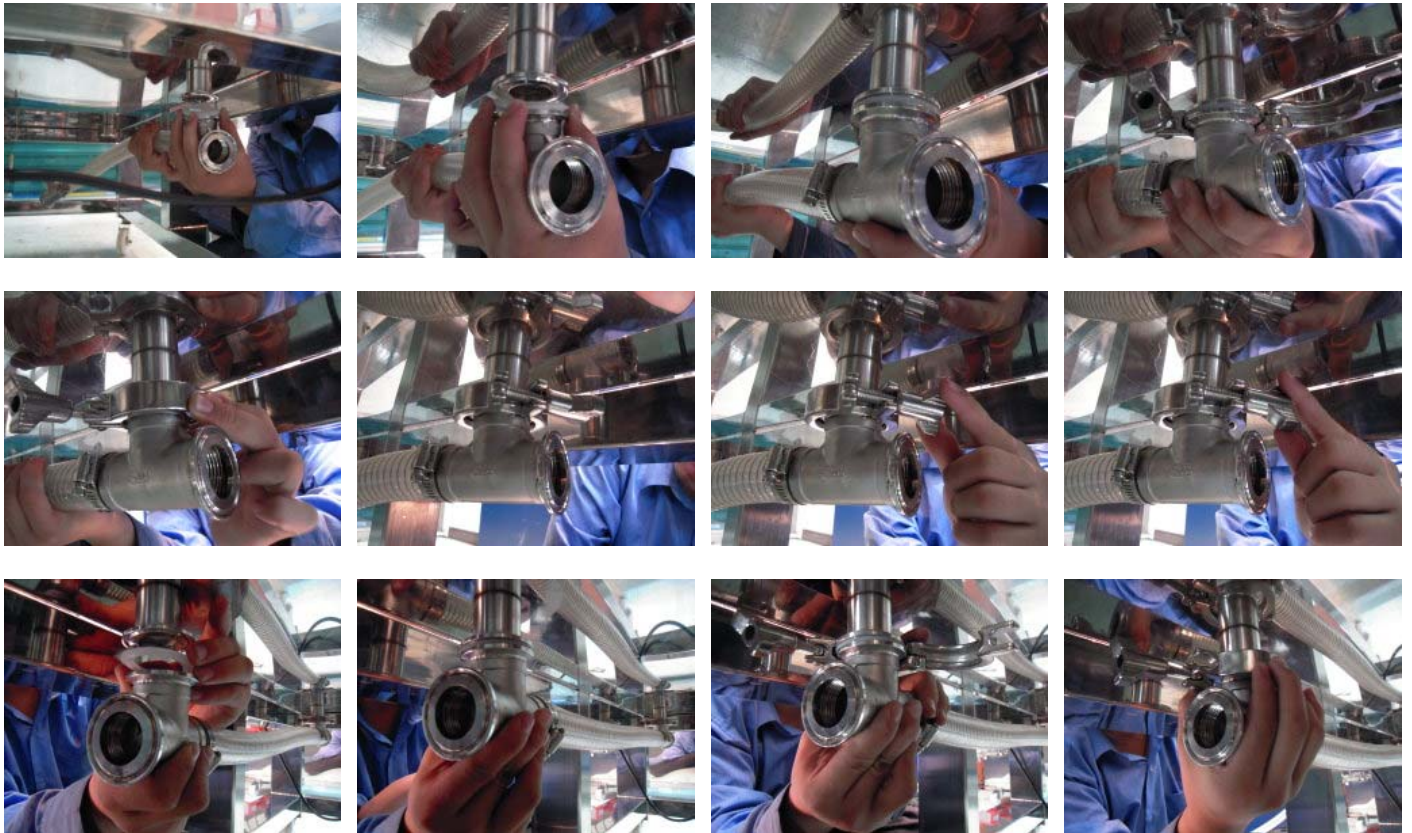



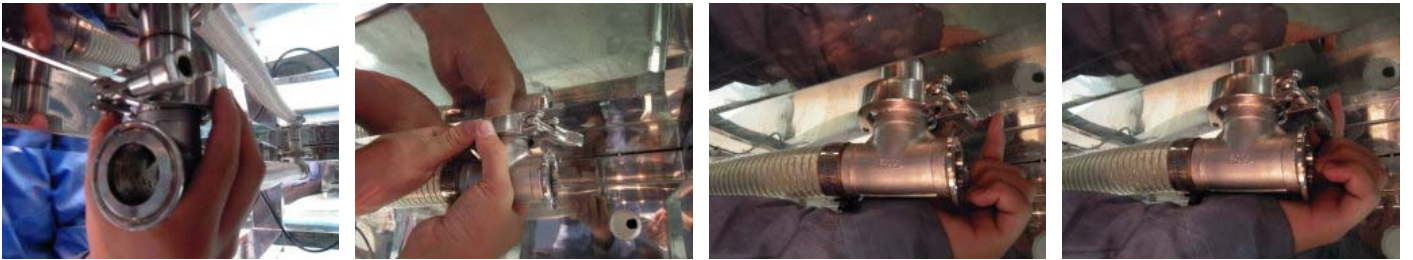

再沒有連接除水槽的一頭，封上盲版。 Seal the side without connection to water trough.

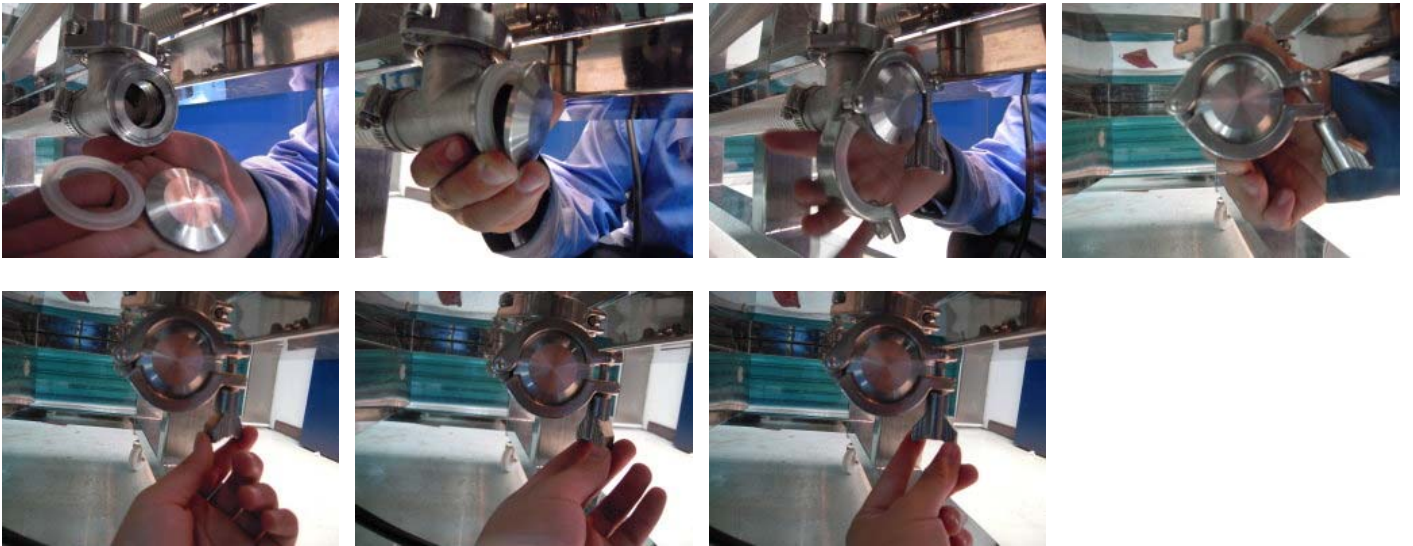

## 6. 儲水槽安裝方式

儲水槽安裝方法 Fabrication and pipes connection of water trough.



水槽排水管連接 The combination of the water trough drain pipe.







沒有使用的孔請用封住（在水槽與機組的另一側，上下兩個） Please seal the useless hole with the tools below. (On another side of the water trough, there are two holes, top one and bottom one)

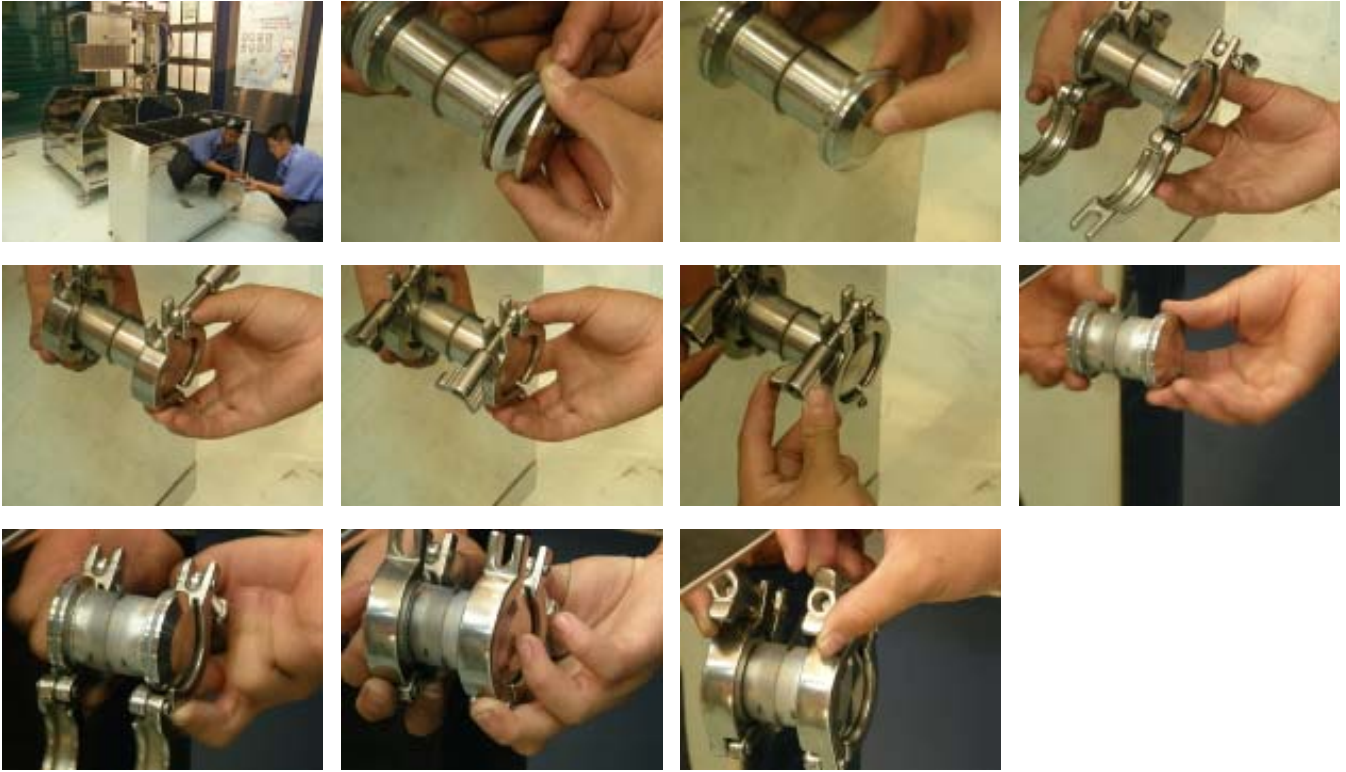

沉水馬達與機組入水快接連接 The connection of water pump pipe and three way valve.

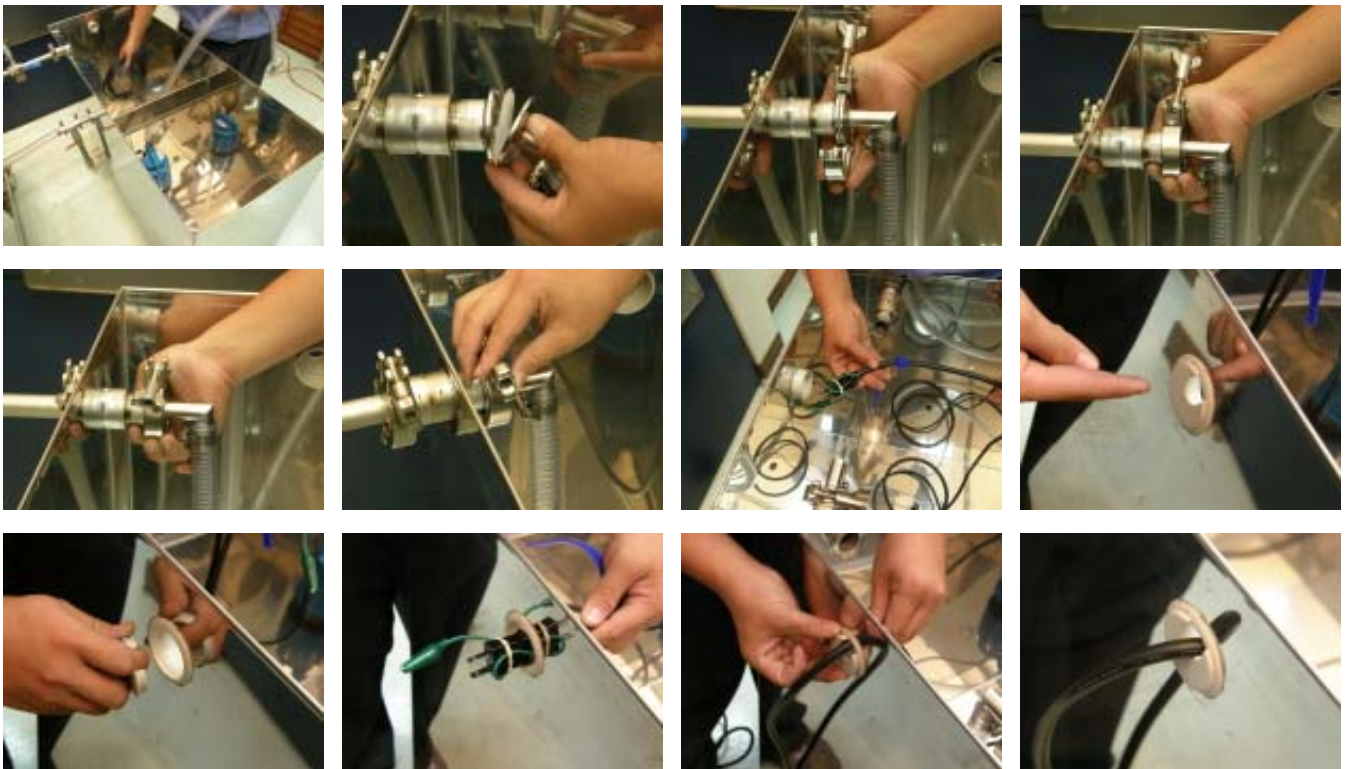

水槽左側、右側及後側擺放圖示 The situation of the water trough.



左側 On the left side of the machine.

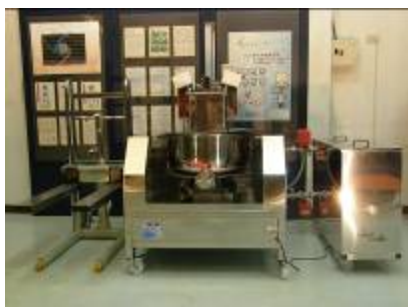

不含油壓板車操作空間 the operation room without forklift.

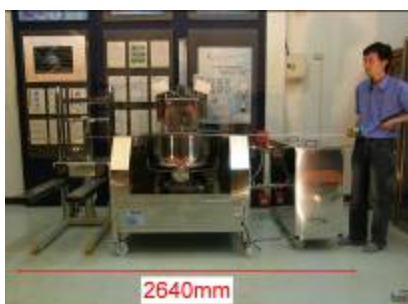

包含油壓板車操作空間 the operation room with forklift.

右側 One the right side of the machine.



不含油壓板車操作空間 the operation room without forklift.



包含油壓板車操作空間 the operation room with forklift.

後側 On the back of the machine.



水槽置於機組後側之注意事項：Notice (situation on the back of the machine.)

如水槽需置於機組後側，機組排水與水槽連接管路需使用彎頭。

If the water trough is on the back side of the machine, please use bend connector of the machine water out pipe.



彎頭與矽膠墊圈 bend connector and silica washer.

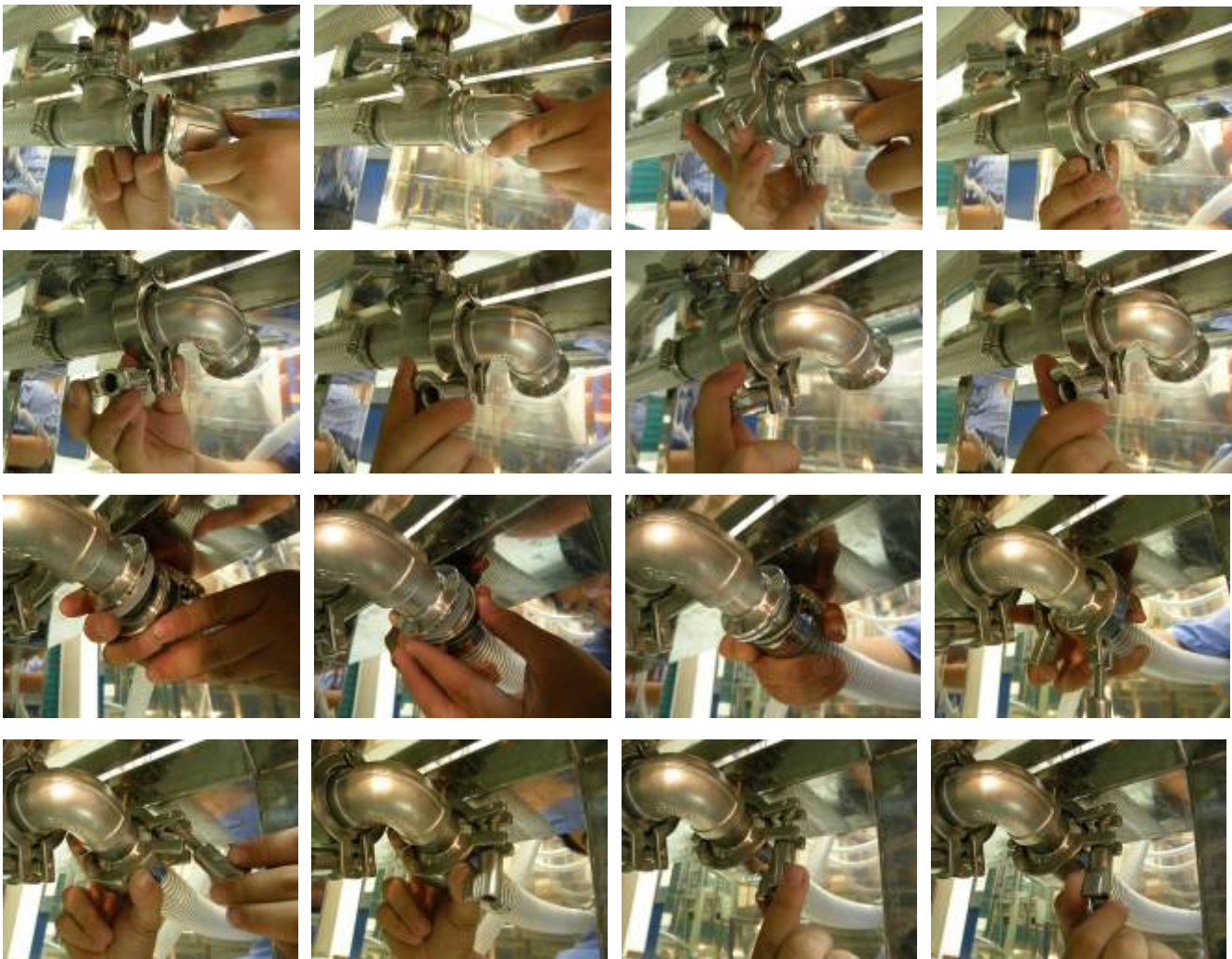





**7. 升降控制系統組裝 Lift up and down control system box.**



先安裝固定快拆式控制器 Put on the control system box.



以六角板手固定控制器 Use no. 6 ratcheting wrench to fasten the control system box.



安裝升降機構軍規接頭 Connect the military plugs.



遙控器置入固定座 Put the remote control into the set.



**8. 安裝攪拌器與控制電源 Stirrer speed and temperature control system box fabrication.**

將攪拌器置入固定座上 Put the stirrer speed and temperature in.



並以工具 5 號六角板手鎖緊固定 Use no. 5 ratcheting wrench to fasten the screws.



安裝控制電源 Connect the wire and fasten the military plugs.

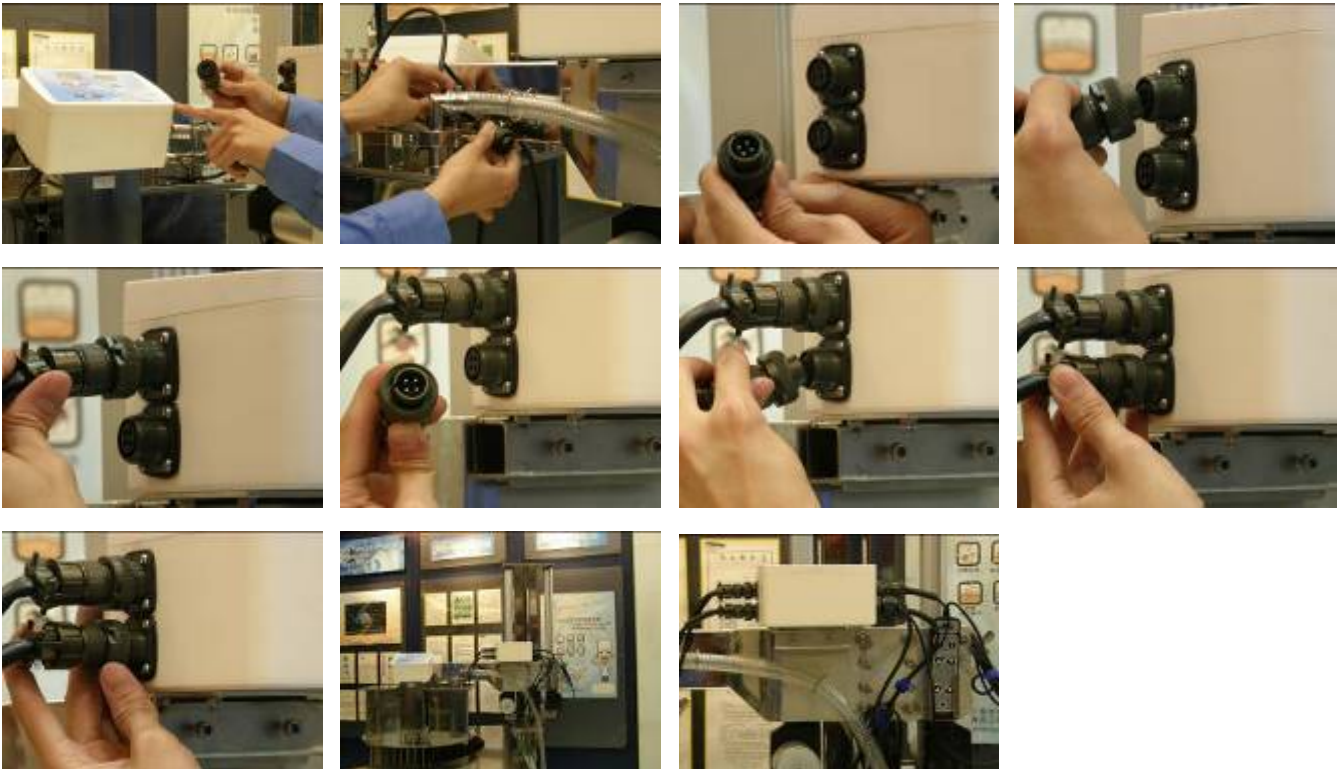

**9. 自動三通閥組裝與機組連接 Auto three way valve assembly**

自動三通閥所需配件 Accessories of fabrication





(1) 請先放上自動三通閥控制器系統。 Please put on the control system and fasten it.



(2) 電動三通閥與水槽連接 The installation of auto three way valve. (water into machine)

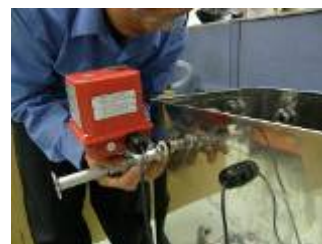

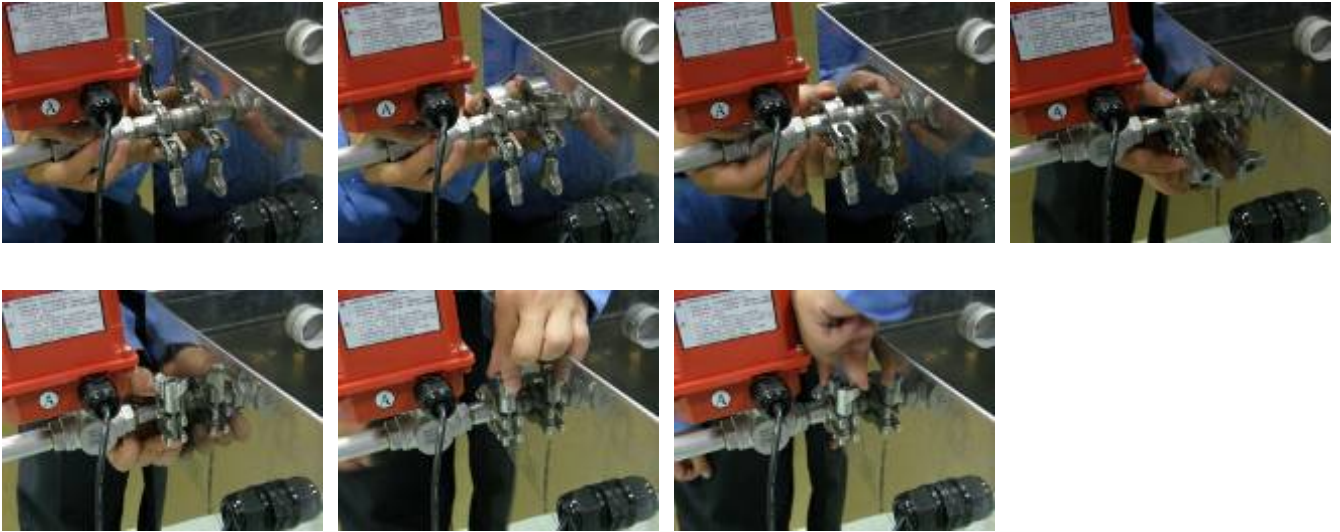

(3) 電動三通閥之電源線與其控制器連接。 Connect the wire of auto three way valve.  
 三通閥 Three way valve



連接時請注意箭頭對箭頭 Please pay attention to the direction of arrows.

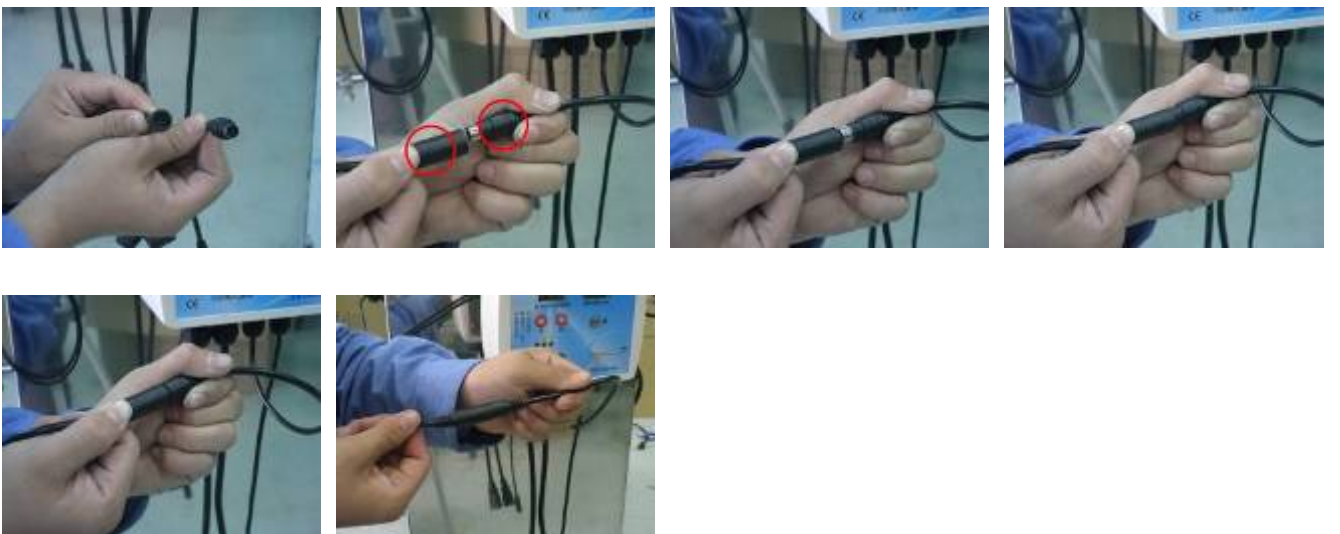

(4) 排水二通閥與水槽連接 The installation of auto two way valve installation (drain water)







二通閥 Two way valve



(5) 請插入安全警示燈 Please put in the warning light.



(6) 將溫度感應棒放入水槽 Put the temperature sensor into water trough.



並將溫度感應棒穿過方形扣環 Put the temperature sensor through the square ring.



請轉緊電纜固定頭，以防電線割傷。

Please fasten the wire bushing to prevent the cutting of temperature sensor wire.



水槽循環泵安裝：將水槽循環泵放至於水槽最底部並固定。 Water circulation pump installation: put the pump on the bottom of water trough and make it immovable.





將水槽循環泵電源線穿過水槽的電線孔，插上插頭即可。Pass the wire of water circulation pump, plug in and the installation is done

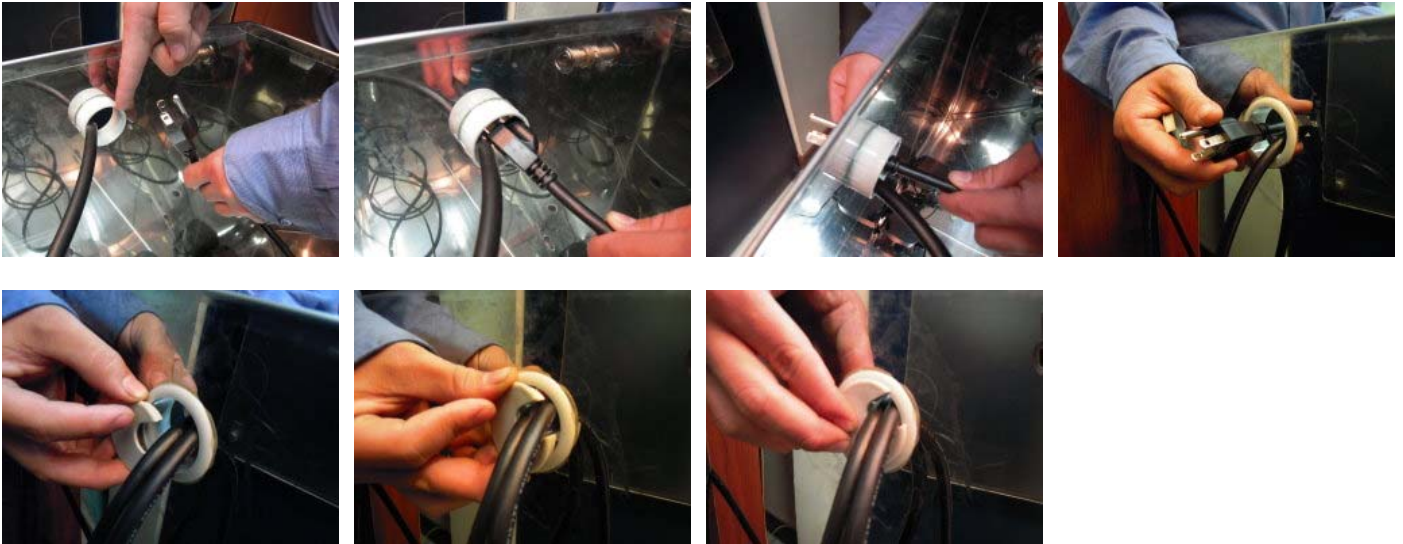

(7) 排水三通彎頭與二通閥連接 The connection of three way drain water bend pipe and auto two way valve.

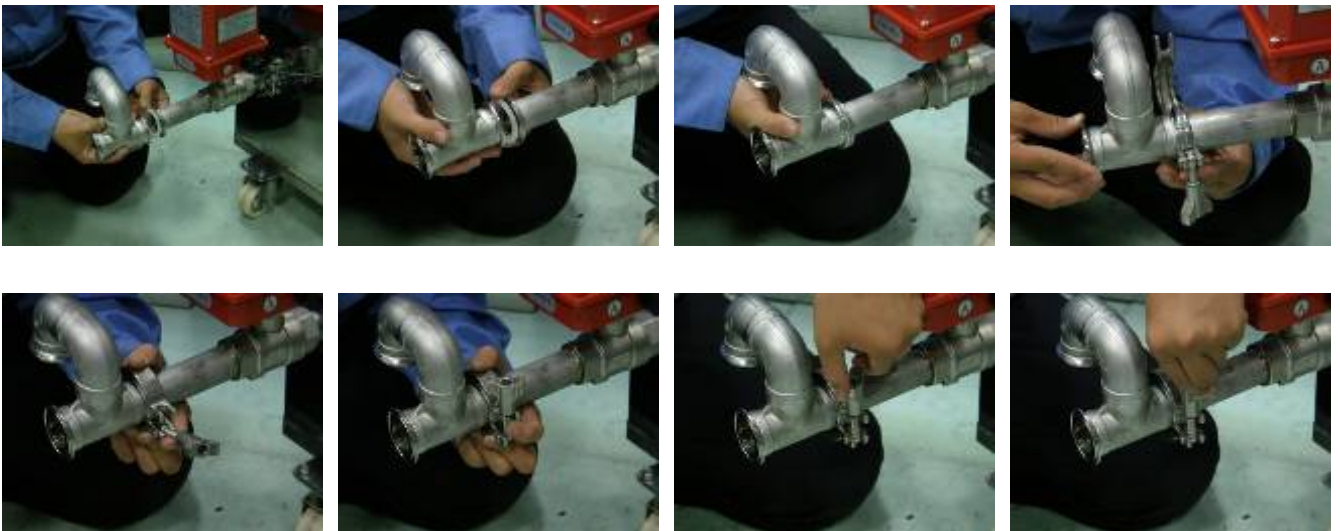

(8) PVC 排水彎管與排水三通彎頭連接 PVC bend pipe and three way drain water bend pipe connection.

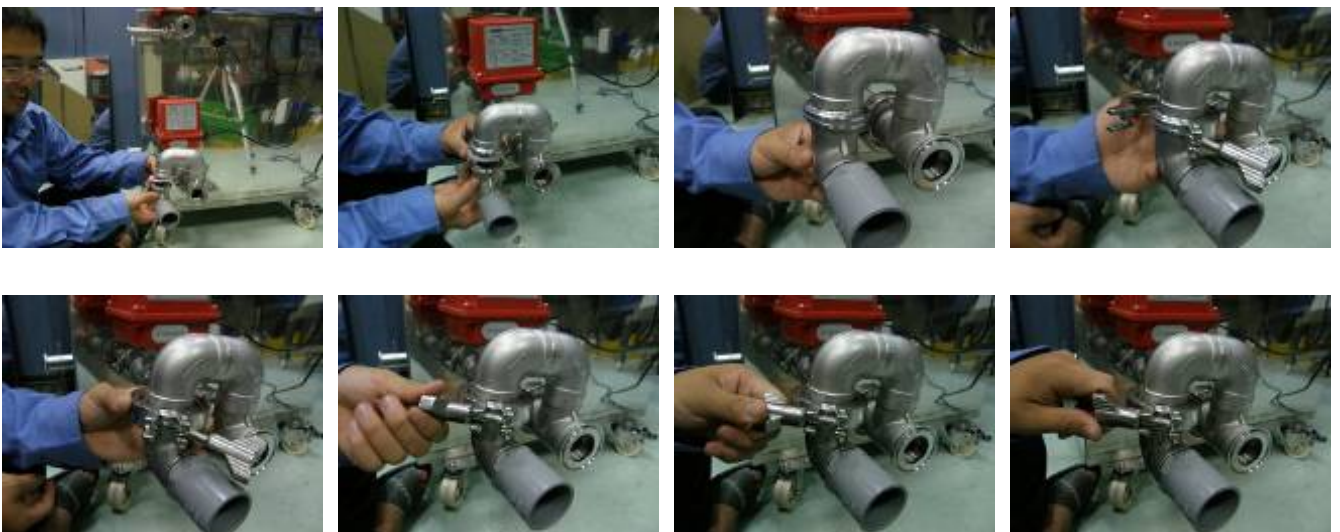



(9) 溢位孔排水管連接 Overflow pipe installation.



(10) 沉水馬達與機組入水管連接 The connection of water pump pipe and water in pipe.





(11) Plug the wire of water pump into the auto three way valve control system box.



(12) 水槽與三通閥組裝完成 The installation of auto three way valve and the water trough is done.



(13) 機組排水管與水槽連結 The connection of NE-15 and water trough

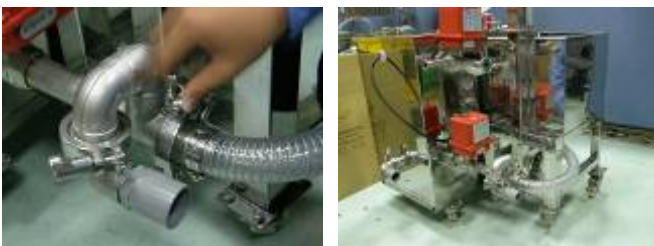

連接排水管即可完成 And connect the water drain pipe. The installation is done.

